

Pos.Nr. Pos.no. Position	Beschreibung Description Désignation	Preisgruppe Price bracket Catégorie de prix	Art.-Nr. Art.no. Réf.
1	Laternenhalter (o. Abb.) Laternholder (no ill.)	108529	2
2	Schraube M 1,6 x 5 Screw M 1,6 x 5	110008	2
3	Kessel komplett Betr.-Nr.: 23 1020 Body assembly Loco no.: 23 1020	112714	70
4	Lackiertes Führerhaus Drivers cab	112722	35
5	Umlauf Gangway	112723	20
6	Teilesatz Parts set	112008	20
7	Fenstersatz Window set	112009	22
8	Teilesatz Parts set	112010	12
9	Kesselgewicht Boiler weight	112011	10
10	Griffstangensatz Handrail set	112013	22
11	Leitungssatz Tube set	112014	8
12	Teilesatz Parts set	112019	15
13	Teilesatz Parts set	112020	25
14	Teilesatz Parts set	112021	7
15	Deckel für Vorwärmer Cover for Preheating	112022	3
16	Windleitblechsatz Smoke deflector set	112023	15
17	Tafelsatz "Jugendlok" (o. Abb.) Number set "Jugendlok" (no ill.)	112724	20

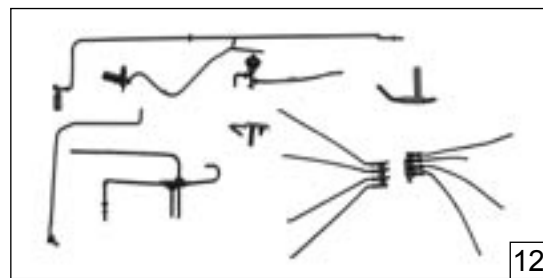

17 o. Abb. / no ill.  
Tafelsatz "Jugendlok"  
Number board "Jugendlok"

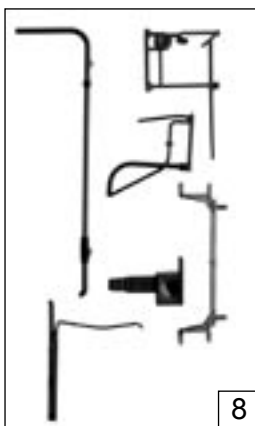
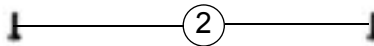
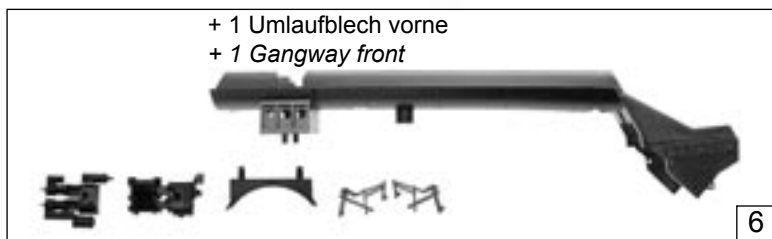
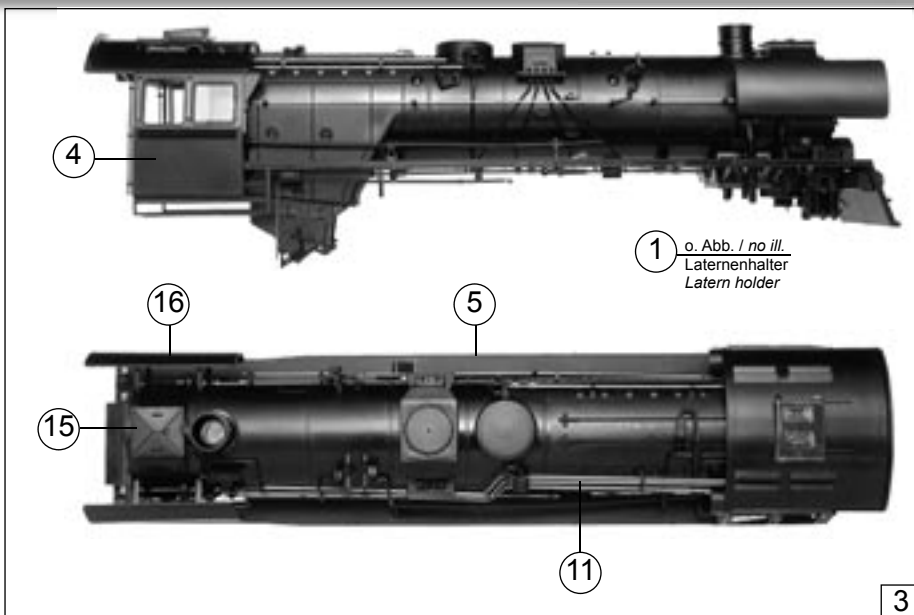
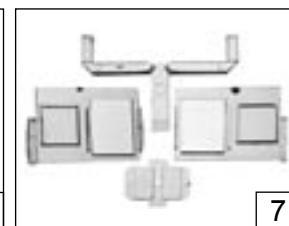
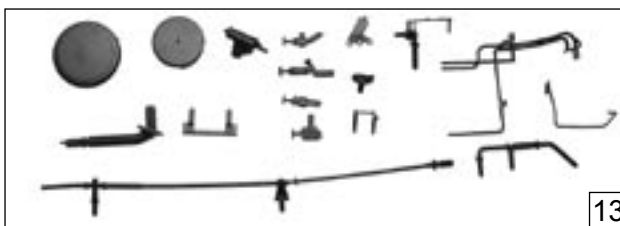
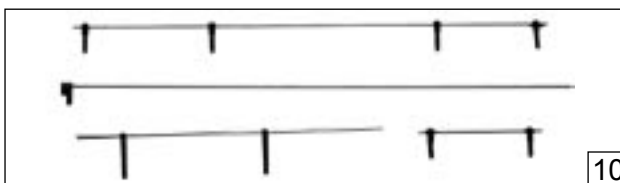

Pos.Nr. Pos.no. Position	Beschreibung Description Désignation	Preisgruppe Price bracket Catégorie de prix	Art.-Nr. Art.no. Réf.
1	Schraube M 2 x 6 Screw M 2 x 6	85672	2
2	Schraube M 2 x 4 Screw M 2 x 4	85817	2
3	Schraube M 2 x 25 Screw M 2 x 25	85759	3
5	Beilagscheibe Washer	86102	2
6	Zugfeder Spring	86208	2
7	Zahnrad z=17 Gear t=17	86418	2
8	Schnecken Zahnrad Worm gear	86490	4
9	Puffer flach Buffer flat	88502	4
10	Puffer gewölbt Buffer vaulted	88503	4
11	Schneckenachslager Worm axle	89749	6
12	Schiebereinsatz Slider insert	92420	2
13	Kardankugel Cardan ball	95797	2
14	Schneckensatz Worm set	100132	24
15	Drahtlampe 16 V Light bulb 16 V	109321	10
16	Bolzen Pin	111218	2
17	Kardanschale Cardan bearing	111764	4
18	Schneckendeckel Worm cover	111987	3
19	Lokplatine komplett Loco printed circuit assembly	112712	49
20	Steuerung komplett Steering assembly	111989	73
21	Kuppelstange, bedruckt Connecting rod, printed	111990	9
22	Bolzen 3,85 Pin 3,85	111993	2
23	Radsatz 1 Wheelset 1	112716	20
24	Radsatz 2 Wheelset 2	112717	20
25	Radsatz 3 Wheelset 3	112718	20
26	Lokgrundrahmen Main frame	112719	30
27	Teilesatz Parts set	111999	15
28	Lok-Tender-Kupplung Loco-tender coupling	112001	10
29	Zylinderblock Cylinder block	112002	20
30	Teilesatz Parts set	112015	20
31	Vorlaufeder Pilot spring	112016	2
32	Vorlaufadsatz Pilot wheelset	112017	14
33	Nachlaufadsatz Tail wheelset	112018	14
34	Nachlaufgewicht (ohne Abbildung) Tail weight (no ill.)	112142	3
35	Nachlaufgestellfeder (o. Abb.) Tail spring (no ill.)	112720	2
<b>~ Wechselstrom / AC 69232</b>			
36	Wechselstromschleifer Whisper wiper	40064	-
37	Schraube M 1,6 x 6 Screw M 1,6 x 6	85811	2
38	Kontaktstift Contact Pin	100893	2
39	Lokplatine komplett Loco printed circuit assembly	112735	49
40	Nachlaufadsatz Tail wheelset	112107	14
41	Vorlaufadsatz Pilot spring	112108	14
42	Isolierbuchse (o. Abb.) Insulating shaft (no ill.)	112109	2
43	Radsatz 1 Wheelset 1	112737	20
44	Radsatz 2 Tail wheelset 2	112738	20
45	Radsatz 3 Tail wheelset 3	112739	20
46	Nachlaufgestellfeder (o. Abb.) Tail spring (no ill.)	112740	2
47	Schraube M 2 x 25 Screw M 2 x 25	85807	2
48	Schraube M 2 x 8 Screw M 2 x 8	85814	2

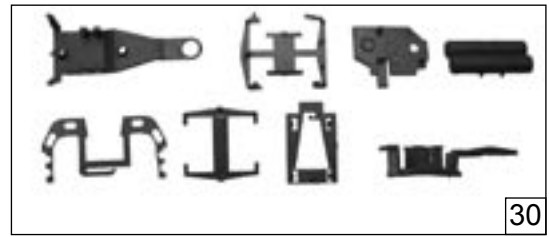
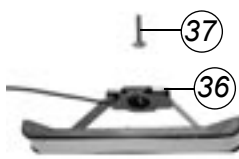
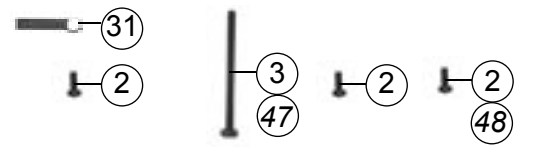
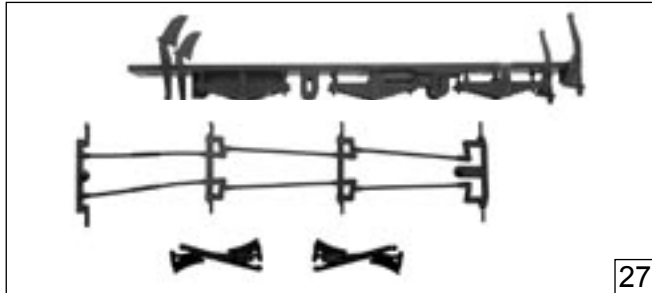
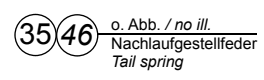
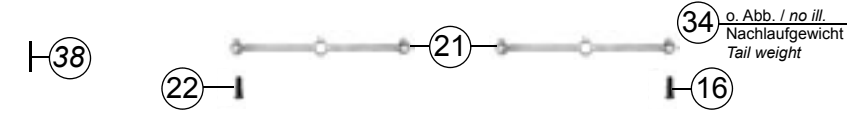
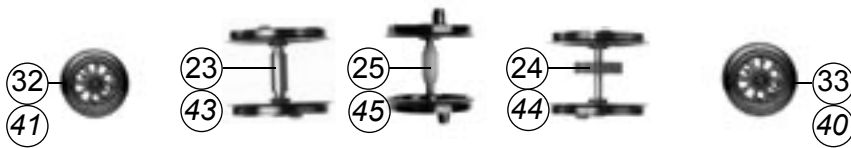
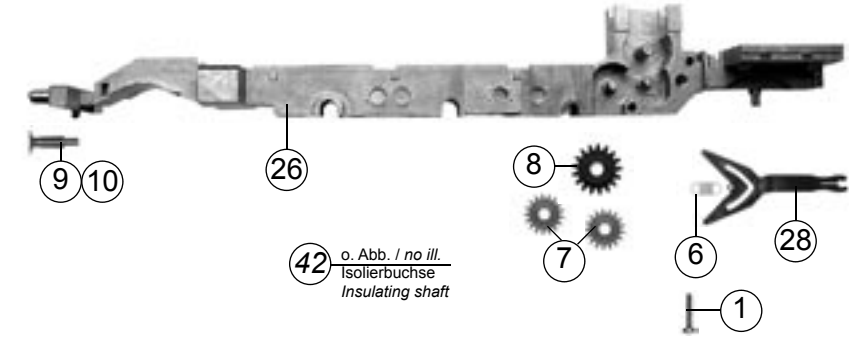
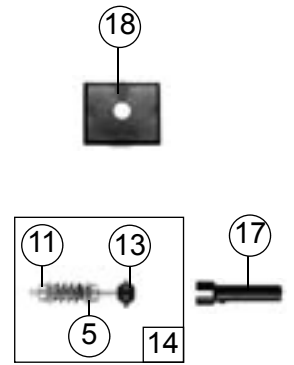
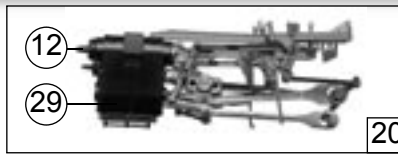

Pos.Nr. Pos.no. Position	Beschreibung Description Désignation	Preisgruppe Price bracket Catégorie de prix	Art.-Nr. Art.no. Réf.
1	Schraube M 1,6 x 10 Screw M 1,6 x 10	85699	2
2	Kardanhülse Cardan bearing	87129	3
3	Brückenstecker Bridge connector	100644	7
4	Tenderplatine Tender, printed circuit	109398	48
5	Tendergewicht Tender weight	109405	10
6	Schraube M 1,6 x 5 Screw M 1.6 x 5	110008	2
7	Kardanwelle Cardan axle	111765	3
8	Teilesatz Parts set	112713	24
9	Motor Motor	85131	57
10	Teilesatz Parts set	112024	8
11	Tender Lichtleiter Tender light transmission bar	112025	3
12	Tendergehäuse Tender casing	112721	33

**~ Wechselstrom / AC 69232**

13	Motorola Lokdecoder lastge- regelt Decoder "Motorola" load regulated	10738	-
14	Tenderplatine komplett Tender printed circuit assembly	109890	48

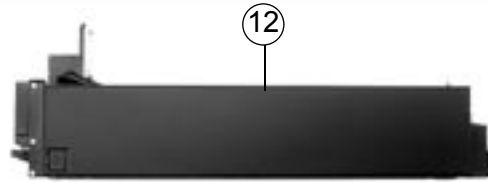

Symbolische Darstellung  
Symbolic Illustration  
Illustration figurative

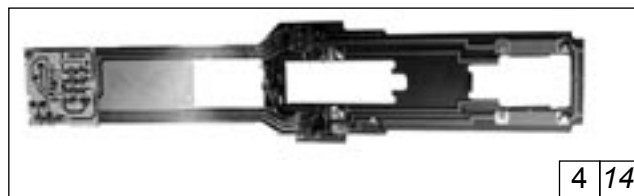
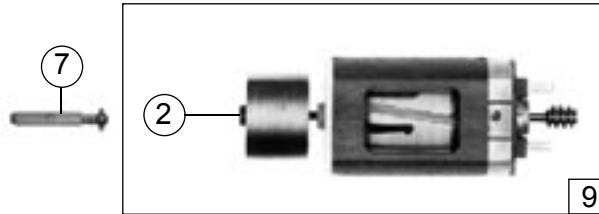
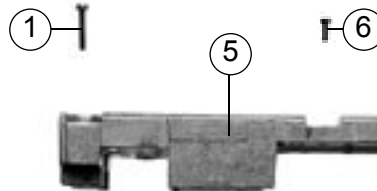
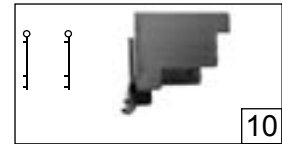
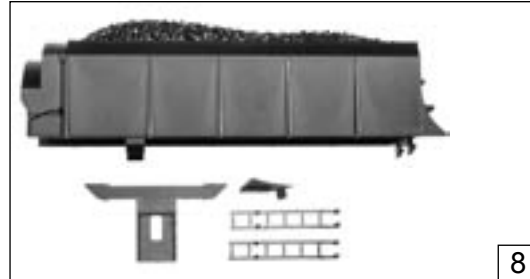

Pos.Nr. Pos.no. Position	Beschreibung Description Désignation	Preisgruppe Price bracket Catégorie de prix	Art.-Nr. Art.no. Réf.
1	Hafringesatz Traction tires set	85622	19
2	Ansatzschraube Screw	85669	3
3	Schraube M2 x 4 Screw M2 x 4	85670	2
4	Zahnrad z=19 Gear t=19	86417	2
5	Zahnrad z=17 Gear t=17	86418	2
6	Schneckenzahnrad Worm gear	86490	4
7	Puffer flach Buffer flat	88556	4
8	Puffer gewölbt Buffer vaulted	88557	4
9	Universalkupplung Universal coupling	89282	5
10	Radsatz ohne Zahnrad Wheelset without gear	90451	20
11	Radsatz mit Hafring und Zahnrad Wheelset with traction tires and gear	90690	18
12	Tenderleitungssatz Tender tube set	100166	8
13	Teilesatz Parts set	100167	10
14	Kupplungskammer Coupling holder	108225	3
15	Laufgestelldruckfeder Spring	108226	2
16	Tender-Blende Tender-Bogie	108227	12
17	Tendergetriebebesatz Tender Gear set	100136	24
18	Tendergrundrahmen Tender main frame	113316	30
19	Zurüstbeutel (o. Abb.) Bag with accessories (no ill.)	111992	32
20	Tafelsatz (o. Abb.) Numberboard set (no ill.)	112715	20
<b>~ Wechselstrom / AV 69232</b>			
21	Hafringesatz AC Traction tires set AC	85623	16
22	Tenderradsatz Tender wheelset	108304	18
23	Radsatz mit 2 Hafringen Wheelset with 2 traction tires	109889	20

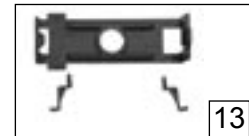
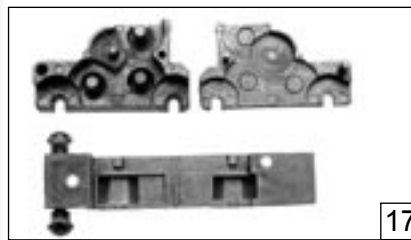
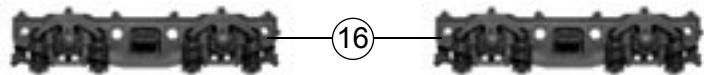
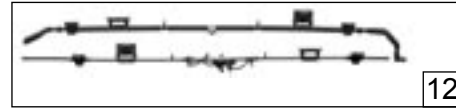
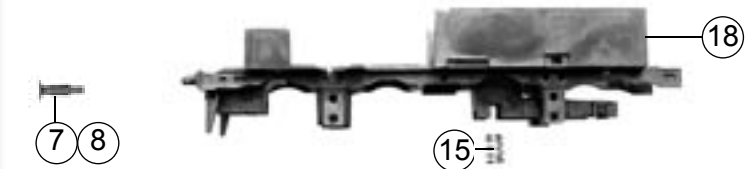

19 o. Abb. / no ill.  
Zurüstbeutel  
Bag with accessories

20 o. Abb. / no ill.  
Tafelsatz  
Numberboard set

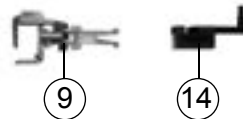

Ersatzteile erhalten Sie bei Ihrem Fachhändler, Ihrer Landesvertretung, oder bei:  
*You can order your Replacement Parts at your local dealer, your country representative, or:*  
Passez commande des pièces détachées chez votre détaillant, chez le S.A.V. de votre importateur national ou en direct au S.A.V.  
ROCO:

**ROCO Modellspielwaren VertriebsgmbH & Co. Handels KG - Service -**  
**Georg-Wrede-Straße 49**  
**D-83395 Freilassing**  
☎ +49 / (0)86 54 / 47 63 0  
Fax: +49 / (0)86 54 / 47 63 50  
E-Mail: service@roco-online.de